

REV	E00	REV BY	DATE	APPD	DATE
-----	-----	--------	------	------	------

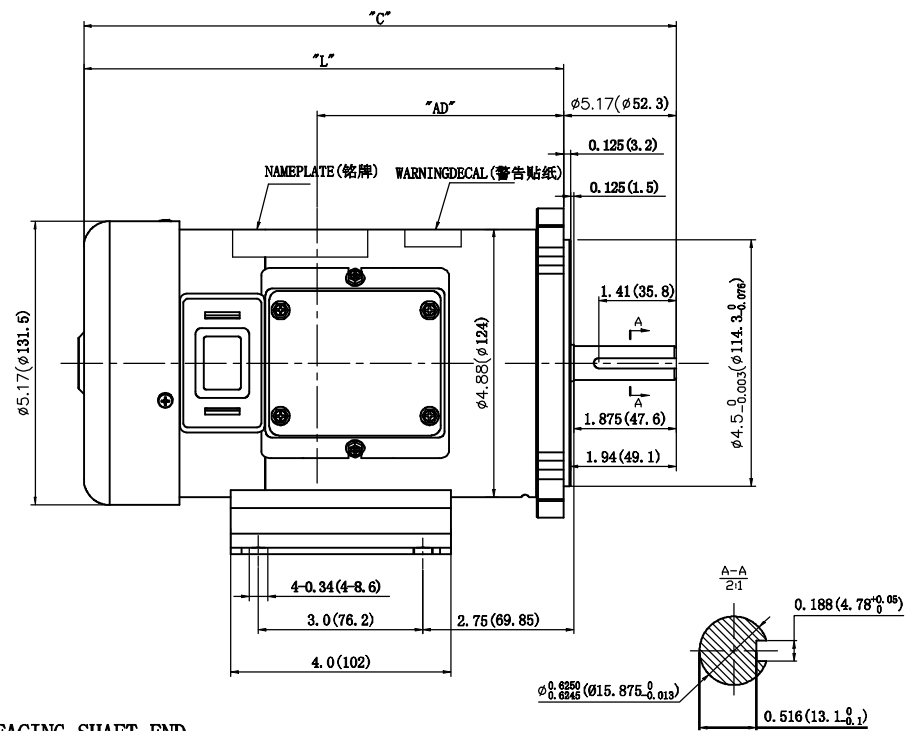

MOTOR ROTATION: CW FACING SHAFT END

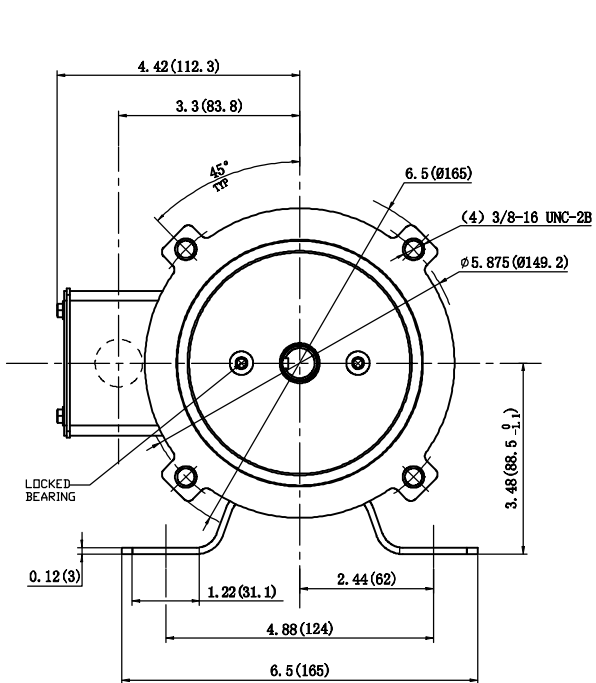
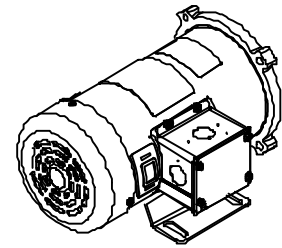

IND#	VOLTS DC	AMPS	HP	RPM	N.m	"C"	"L"	"AD"	INSULATION Class	MODEL
PM002	90	2.5	1/4	1750	1.01	10.81	8.75	4.49	F	ZTT42-01
PM003	180	1.4	1/4	1750	1.01	11.31	9.25	4.99	F	ZTT42-02
PM004	90	3.5	1/3	1750	1.36	11.31	9.25	4.99	F	ZTT42-03
PM005	180	1.7	1/3	1750	1.36	11.31	9.25	4.99	F	ZTT42-04
PM000	90	5	1/2	1750	2.03	11.81	9.75	5.49	F	ZTT42-05
PM008	180	2.5	1/2	1750	2.03	11.81	9.75	5.49	F	ZTT42-06
PM032	90	7.6	0.75	1750	3.06	13.81	11.75	7.49	F	ZTT42-07
PM069	180	3.8	0.75	1750	3.06	13.81	11.75	7.49	F	ZTT42-08
PM006	90	5.0	1/2	2500	1.42	10.81	8.75	4.49	F	ZTT42-09
PM007	180	2.5	1/2	2500	1.42	10.81	8.75	4.49	F	ZTT42-10
PM009	90	7.6	0.75	2500	2.14	11.81	9.75	5.49	F	ZTT42-11
PM010	180	3.8	0.75	2500	2.14	11.81	9.75	5.49	F	ZTT42-12

DR BY:	
APPD:	
FIRST ANGLE PROJECTION	EDS DATE VERSION
CONFIDENTIAL: THIS DRAWING AND INFORMATION HEREIN ARE THE CONFIDENTIAL AND PROPRIETARY PROPERTY OF AG-I MOTORTEC INC., AND SHOULD NOT BE REPRODUCED, DISCLOSED, OR OTHERWISE USED WITHOUT WRITTEN CONSENT FROM AG-I MOTOR TEC INC.	

		AG-I MOTORTEC INC.,	
DESCRIPTION			
SIZE	A3	DWG NO	
SCALE			SHEET